

ATTENTION: Refer to the appropriate shop manual for your vehicle to obtain specific service procedures for this part. If you do not have a service manual or lack the skill to install this part, it is recommended that you seek the services of a qualified technician. Pay special attention to all cautions and warnings included in the shop manual. Read and follow all instructions carefully.

Chrysler Town & Country, Dodge Caravan, Dodge Grand Caravan 2007–04

NOTE: READ INSTRUCTIONS THOROUGHLY BEFORE INSTALLATION WORK BEGINS.

The following instructions describe a technique for installing your new window regulator. The driver's side is shown in this example.

STEP 1: Cut the wire tie which holds the cable to the motor. Insert the bottom end of the left rail through the left hole, sliding it as far forward as possible to allow the top of the rail to fit in.

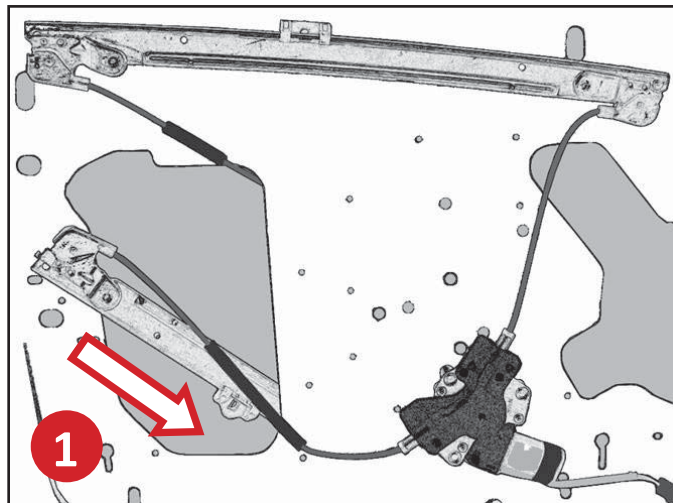

STEP 2: Insert the top of the right rail into the right hole. The end of the rail will slide up between the glass and the door to allow the bottom of the rail to be inserted. Mount the rails to the door loosely. Attach the glass to the regulator and adjust the rails for proper alignment.

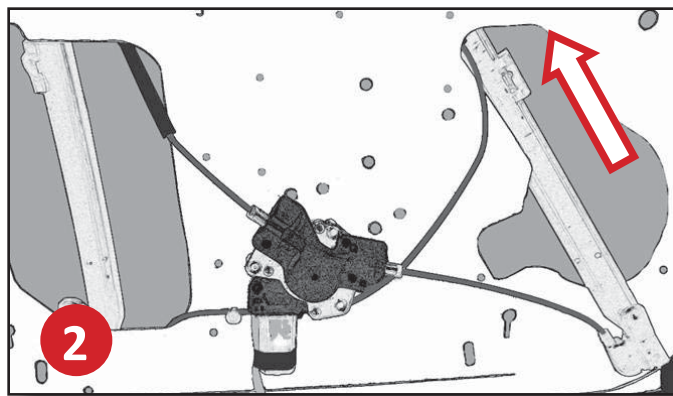

Disclaimer:

Even though every attempt is made to ensure this information is complete and accurate, it is impossible to account for all possible circumstances or situations. Please consult with a qualified auto technician before attempting to perform any work you are not qualified to do. Automobiles can be hazardous to work on; be sure to take all necessary safety precautions. Failure to do so may result in property damage or personal injury. Certain motor vehicle standards and performance requirements may apply to your motor vehicle (such as Federal Motor Vehicle Safety Standards by the National Highway Traffic Safety Administration). Be sure that your work is performed in accordance with such standards and that you do not disable any motor vehicle safety feature.

ATTENTION: Refer to the appropriate shop manual for your vehicle to obtain specific service procedures for this part. If you do not have a service manual or lack the skill to install this part, it is recommended that you seek the services of a qualified technician. Pay special attention to all cautions and warnings included in the shop manual. Read and follow all instructions carefully.

STEP 3: Install the three motor bolts where the plastic OE rivets were. Ensure that the cable crosses behind the motor as shown and is free to slide up and down. Cable routing is important!

Proper installation of the regulator is shown at right.

Note the orientation of the motor and routing of the cable behind the plate and between the mounting bolts. Having the cable in this position allows re-installation of the door panel and smooth operation of the window regulator.

STEP 4: The slots on the door for the window regulator rails to mount to are there to allow for proper alignment of the window regulator assembly. Make any necessary adjustments to the orientation of the rails to ensure that the window glass moves freely within the window tracks, and the window glass is correctly positioned when fully closed.

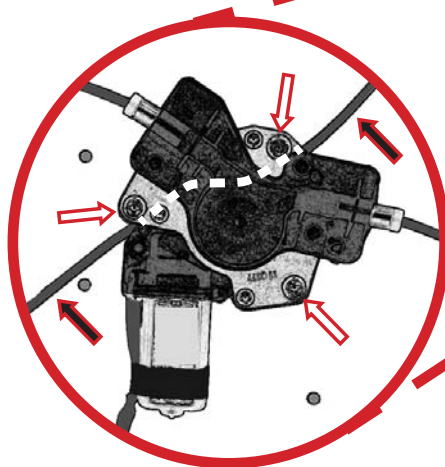
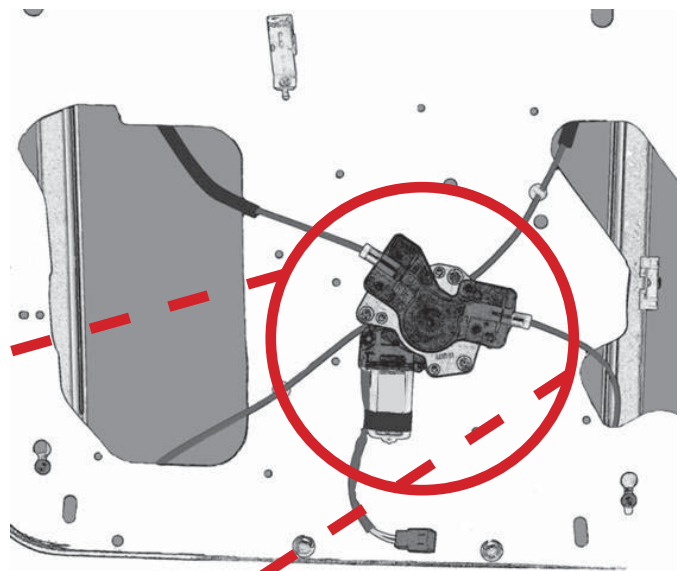
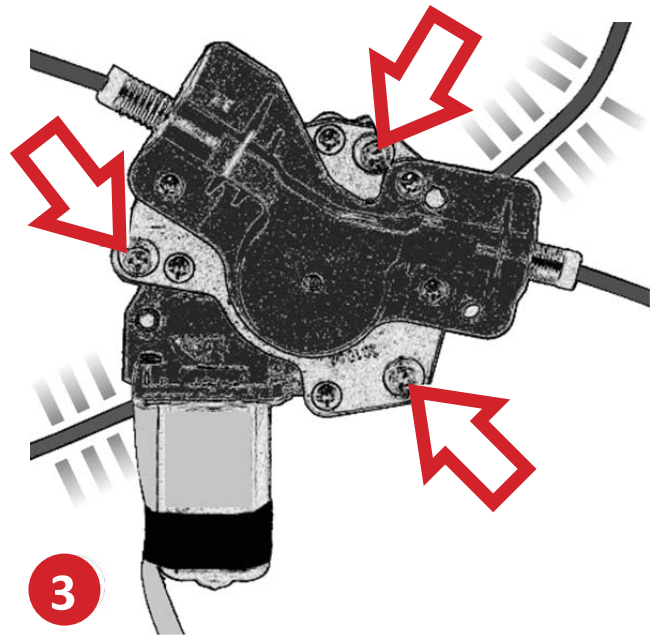

Disclaimer:

Even though every attempt is made to ensure this information is complete and accurate, it is impossible to account for all possible circumstances or situations. Please consult with a qualified auto technician before attempting to perform any work you are not qualified to do. Automobiles can be hazardous to work on; be sure to take all necessary safety precautions. Failure to do so may result in property damage or personal injury. Certain motor vehicle standards and performance requirements may apply to your motor vehicle (such as Federal Motor Vehicle Safety Standards by the National Highway Traffic Safety Administration). Be sure that your work is performed in accordance with such standards and that you do not disable any motor vehicle safety feature.