

ATTENTION: Refer to the appropriate shop manual for your vehicle to obtain specific service procedures for this part. If you do not have a service manual or lack the skill to install this part, it is recommended that you seek the services of a qualified technician. Pay special attention to all cautions and warnings included in the shop manual. Read and follow all instructions carefully. This product is only designed to function properly on specific vehicle applications. Please verify that the vehicle requirements match the product specifications and application notes for this part.

REMOVAL/INSTALL OF BLEND DOOR REPAIR KIT (902-309)

Dodge Ram 1500 2006–02, Dodge Ram 2500 2006–03, Dodge Ram 3500 2006–03

GENERAL TECH TIPS:

- **WARNING:** On vehicles equipped with air-bags, disable the airbag system before attempting any steering wheel, steering column, or instrument panel component diagnosis or service. Disconnect and isolate the battery negative (ground) cable, then wait two minutes for the airbag system capacitor to discharge before performing further diagnosis or service. This is the only sure way to disable the airbag system. Failure to take the proper precautions could result in an accidental airbag deployment and possible personal injury.
- **NOTE:** The HVAC housing must be removed from the vehicle and the two halves of the housing separated for service access of the heater core, evaporator coil, defrost door, blend door(s) and the recirculation door.

**PLEASE WEAR
SAFETY GLASSES!**

Removal Instructions

STEP 1: Disconnect and isolate the battery negative cable.

STEP 2: Drain the engine cooling system.

STEP 3: Recover the refrigerant from the refrigerant system.

STEP 4: Disconnect the liquid refrigerant line fitting from the evaporator inlet tube. Discard the O-ring seal and install plugs in, or tape over the opened liquid refrigerant line fitting and evaporator inlet tube.

STEP 5: Remove the accumulator. Discard the O-ring seals and install plugs in, or tape over the opened refrigerant line fittings and evaporator outlet tube.

STEP 6: Disconnect the heater hoses from the heater core tubes. Install plugs in, or tape over the opened heater core tubes.

STEP 7: Remove the powertrain control module (PCM) from the engine compartment to gain access to the HVAC housing retaining nuts.

STEP 8: Remove the two nuts from the HVAC housing mounting studs in the engine compartment.

STEP 9: Remove the instrument panel from the vehicle.

Disclaimer:

Even though every attempt is made to ensure this information is complete and accurate, it is impossible to account for all possible circumstances or situations. Please consult with a qualified auto technician before attempting to perform any work you are not qualified to do. Automobiles can be hazardous to work on; be sure to take all necessary safety precautions. Failure to do so may result in property damage or personal injury. Certain motor vehicle standards and performance requirements may apply to your motor vehicle (such as Federal Motor Vehicle Safety Standards by the National Highway Traffic Safety Administration). Be sure that your work is performed in accordance with such standards and that you do not disable any motor vehicle safety feature.

REMOVAL/INSTALL INSTRUCTIONS: BLEND DOOR REPAIR KIT

ATTENTION: Refer to the appropriate shop manual for your vehicle to obtain specific service procedures for this part. If you do not have a service manual or lack the skill to install this part, it is recommended that you seek the services of a qualified technician. Pay special attention to all cautions and warnings included in the shop manual. Read and follow all instructions carefully. This product is only designed to function properly on specific vehicle applications. Please verify that the vehicle requirements match the product specifications and application notes for this part.

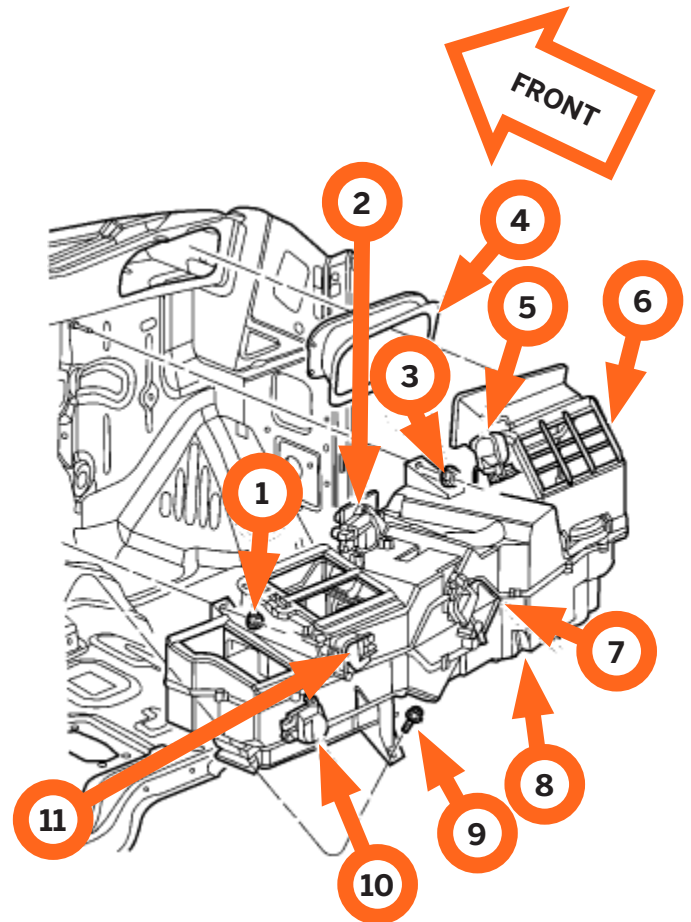

HVAC Housing - Dual Zone Shown, Single Zone Typical

STEP 10: Remove the bolt that secures the HVAC housing to the floor bracket located in the center of the vehicle.

STEP 11: Remove the two nuts from the HVAC housing mounting studs in the passenger compartment.

STEP 12: Remove the HVAC housing from inside the vehicle. Take care not to allow any remaining coolant to drain onto the vehicles interior. Place the HVAC housing on a workbench.

- 1: Nut
- 2: Passenger Blend Door Actuator
- 3: Inlet Baffle
- 4: Recirculation Door Actuator
- 5: Recirculation Door
- 6: Driver Side Blend Door Actuator
- 7: HVAC Housing
- 8: Bolt
- 9: Defroster Door Actuator
- 10: Mode Door Actuator

Disclaimer:

Even though every attempt is made to ensure this information is complete and accurate, it is impossible to account for all possible circumstances or situations. Please consult with a qualified auto technician before attempting to perform any work you are not qualified to do. Automobiles can be hazardous to work on; be sure to take all necessary safety precautions. Failure to do so may result in property damage or personal injury. Certain motor vehicle standards and performance requirements may apply to your motor vehicle (such as Federal Motor Vehicle Safety Standards by the National Highway Traffic Safety Administration). Be sure that your work is performed in accordance with such standards and that you do not disable any motor vehicle safety feature.

ATTENTION: Refer to the appropriate shop manual for your vehicle to obtain specific service procedures for this part. If you do not have a service manual or lack the skill to install this part, it is recommended that you seek the services of a qualified technician. Pay special attention to all cautions and warnings included in the shop manual. Read and follow all instructions carefully. This product is only designed to function properly on specific vehicle applications. Please verify that the vehicle requirements match the product specifications and application notes for this part.

STEP 13: Disconnect the electrical connectors from the blower motor, blower motor resistor block, evaporator temperature sensor and each actuator.

STEP 14: Remove the HVAC wiring harness from the HVAC housing.

STEP 15: If necessary, remove the blower motor from the HVAC housing.

STEP 16: If necessary, remove the blower motor resistor block from the HVAC housing.

STEP 17: Carefully remove the foam seals from the heater core and evaporator coil tube mounting flange of the HVAC housing. If either seal is deformed or damaged, it must be replaced.

STEP 18: Remove the screws that secure the heater core in the HVAC housing and carefully remove the heater core from the housing.

STEP 19: Use a screwdriver to pry off the four snap clips that help secure the upper and lower HVAC housing halves together.

STEP 20: Remove the screws that secure the upper and lower HVAC housing halves to each other and those that secure the recirculation housing to the upper HVAC housing.

STEP 21: Carefully separate the recirculation housing and the upper HVAC housing from the lower housing.

STEP 22: Remove the broken heater blend doors and replace with new assembly.

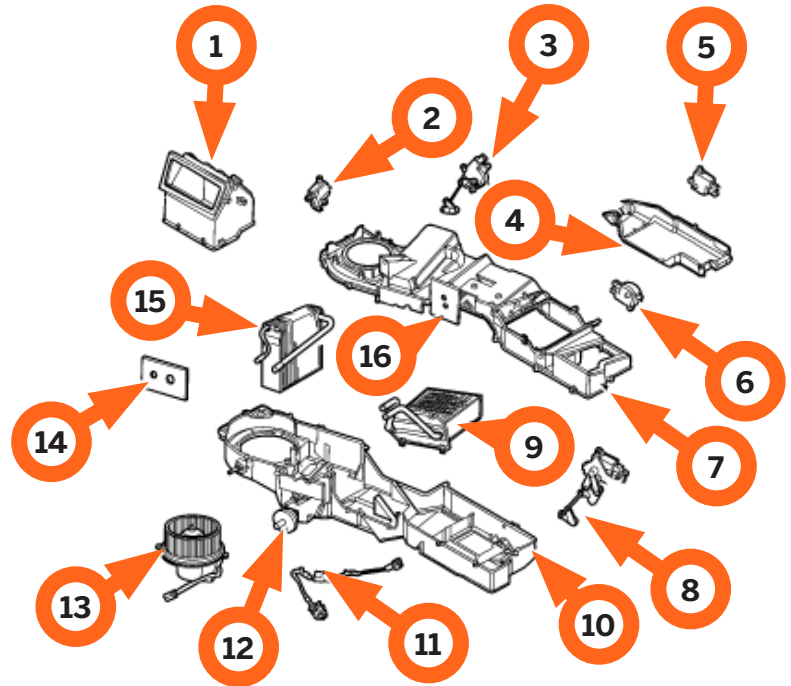

HVAC Housing - Disassembled

- 1: Recirculation Housing
- 2: Recirculation Door Actuator
- 3: Driver Side Blend Door Actuator
- 4: Floor Distribution Duct
- 5: Defrost Door Actuator
- 6: Panel Door Actuator
- 7: Upper HVAC Housing
- 8: Passenger Side Blend Door Actuator
- 9: Heater Core
- 10: Lower HVAC Housing
- 11: HVAC Wire Harness
- 12: Drain Foam Seal
- 13: Blower Motor
- 14: Evaporator Foam Seal
- 15: Evaporator
- 16: Heater Core Foam Seal

Disclaimer:

Even though every attempt is made to ensure this information is complete and accurate, it is impossible to account for all possible circumstances or situations. Please consult with a qualified auto technician before attempting to perform any work you are not qualified to do. Automobiles can be hazardous to work on; be sure to take all necessary safety precautions. Failure to do so may result in property damage or personal injury. Certain motor vehicle standards and performance requirements may apply to your motor vehicle (such as Federal Motor Vehicle Safety Standards by the National Highway Traffic Safety Administration). Be sure that your work is performed in accordance with such standards and that you do not disable any motor vehicle safety feature.

ATTENTION: Refer to the appropriate shop manual for your vehicle to obtain specific service procedures for this part. If you do not have a service manual or lack the skill to install this part, it is recommended that you seek the services of a qualified technician. Pay special attention to all cautions and warnings included in the shop manual. Read and follow all instructions carefully. This product is only designed to function properly on specific vehicle applications. Please verify that the vehicle requirements match the product specifications and application notes for this part.

Installation Instructions

STEP 1: Position the upper HVAC housing to the lower housing. During assembly, be certain of the following:

- a. That each of the door pivot shaft ends are properly engaged in their pivot holes.
- b. That the evaporator drain opening is clean and the drain foam seal is properly installed.

STEP 2: Install the screws and snap clips that secure the upper and lower HVAC housing halves to each other and those that secure the recirculation housing to the upper HVAC housing. Tighten the screws to 2.2 Nm (20 in.·lbs.).

STEP 3: Install the foam seals on the heater core and evaporator coil tubes.

STEP 4: If removed, install the blower motor resistor block.

STEP 5: If removed, install the blower motor.

STEP 6: Install the HVAC wire harness. Make sure the wires are routed through all wiring retainers.

STEP 7: Connect the wire harness to the blower motor, blower motor resistor block, evaporator temperature sensor and each actuator.

STEP 8: Position the HVAC housing into the vehicle. Be certain that the evaporator condensate drain tube and the housing mounting studs are inserted into their correct locations. **NOTE:** If the vehicle is equipped with air conditioning, review the warnings and cautions in plumbing before performing the following operation.

STEP 9: Install the two nuts that secure the HVAC housing to the mounting studs in the passenger compartment. Tighten the nuts to 6.2 Nm (55 in.·lbs.).

STEP 10: Install the bolt that secures the HVAC housing to the floor bracket in the passenger compartment. Tighten the bolt to 6.2 Nm (55 in.·lbs.).

STEP 11: Install the instrument panel.

STEP 12: Install the two nuts that secure the HVAC housing to the mounting studs in the engine compartment. Tighten the nuts to 6.2 Nm (55 in.·lbs.).

STEP 13: Install the powertrain control module (PCM).

STEP 14: Unplug or remove the tape from the heater core tubes and connect the heater hoses to the heater core tubes.

Disclaimer:

Even though every attempt is made to ensure this information is complete and accurate, it is impossible to account for all possible circumstances or situations. Please consult with a qualified auto technician before attempting to perform any work you are not qualified to do. Automobiles can be hazardous to work on; be sure to take all necessary safety precautions. Failure to do so may result in property damage or personal injury. Certain motor vehicle standards and performance requirements may apply to your motor vehicle (such as Federal Motor Vehicle Safety Standards by the National Highway Traffic Safety Administration). Be sure that your work is performed in accordance with such standards and that you do not disable any motor vehicle safety feature.

ATTENTION: Refer to the appropriate shop manual for your vehicle to obtain specific service procedures for this part. If you do not have a service manual or lack the skill to install this part, it is recommended that you seek the services of a qualified technician. Pay special attention to all cautions and warnings included in the shop manual. Read and follow all instructions carefully. This product is only designed to function properly on specific vehicle applications. Please verify that the vehicle requirements match the product specifications and application notes for this part.

STEP 15: Unplug or remove the tape from the opened refrigerant line fittings and the evaporator outlet tube and install the accumulator.

STEP 16: Unplug or remove the tape from the liquid line and the evaporator inlet tube fittings. Connect the liquid line coupler to the evaporator inlet tube.

STEP 17: Evacuate the refrigerant system.

STEP 18: Charge the refrigerant system.

STEP 19: Fill the engine cooling system.

STEP 20: Connect the battery negative cable.

STEP 21: Start the engine and check for proper operation of the heating and air conditioning systems.

Still need help?
Please call our Technical Support team for assistance
from our team of certified automotive experts.
1-800-523-2492

Disclaimer:

Even though every attempt is made to ensure this information is complete and accurate, it is impossible to account for all possible circumstances or situations. Please consult with a qualified auto technician before attempting to perform any work you are not qualified to do. Automobiles can be hazardous to work on; be sure to take all necessary safety precautions. Failure to do so may result in property damage or personal injury. Certain motor vehicle standards and performance requirements may apply to your motor vehicle (such as Federal Motor Vehicle Safety Standards by the National Highway Traffic Safety Administration). Be sure that your work is performed in accordance with such standards and that you do not disable any motor vehicle safety feature.